

Gummisnor / Rubber cord / Gummischnur

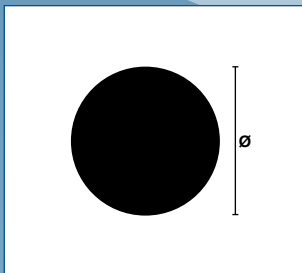

EPDM	
Farve Colour Farbe	Data Data Daten
Sort Black Schwarz	Shore A 65°- 70°
Art.	Ø mm
30.101E	1.0
30.101.25E	1.25
30.102E	2.0
30.103E	3.0
30.104E	4.0
30.105E	5.0
30.106E	6.0
30.107E	7.0
30.108E	8.0
30.109E	9.0
30.110E	10.0
30.112E	12.0
30.113E	13.0
30.114E	14.0
30.115E	15.0
30.116E	16.0
30.117E	17.0
30.118E	18.0
30.119E	19.0
30.120E	20.0
30.121E	21.0
30.122E	22.0
30.123E	23.0
30.124E	24.0
30.125E	25.0

CR	
Farve Colour Farbe	Data Data Daten
Sort Black Schwarz	Shore A 65°
Art.	Ø mm
30.103CR	3.0
30.103.5CR	3.5
30.104CR	4.0
30.104.5CR	4.5
30.105CR	5.0
30.105.3CR	5.3
30.105.7CR	5.7
30.106CR	6.0
30.106.5CR	6.5
30.107CR	7.0
30.107.5CR	7.5
30.108CR	8.0
30.108.4CR	8.4
30.109CR	9.0
30.109.5CR	9.5
30.110CR	10.0
30.111CR	11.0
30.112CR	12.0
30.113CR	13.0
30.114CR	14.0
30.115CR	15.0
30.116CR	16.0
30.118CR	18.0
30.120CR	20.0
30.122CR	22.0
30.125CR	25.0
30.130CR	30.0
30.132CR	32.0
30.140CR	40.0

NBR	
Farve Colour Farbe	Data Data Daten
Sort Black Schwarz	Shore A 65°
Art.	Ø mm
30.103NBR	3.0
30.103.5NBR	3.5
30.104NBR	4.0
30.104.5NBR	4.5
30.105NBR	5.0
30.105.3NBR	5.3
30.105.7NBR	5.7
30.106NBR	6.0
30.106.5NBR	6.5
30.107NBR	7.0
30.107.5NBR	7.5
30.108NBR	8.0
30.108.4NBR	8.4
30.109NBR	9.0
30.109.5NBR	9.5
30.110NBR	10.0
30.111NBR	11.0
30.112NBR	12.0
30.113NBR	13.0
30.114NBR	14.0
30.116NBR	16.0
30.118NBR	18.0
30.120NBR	20.0
30.122NBR	22.0
30.125NBR	25.0
30.130NBR	30.0
30.132NBR	32.0
30.136NBR	36.0
30.140NBR	40.0

SILICONE	
Farve Colour Farbe	Data Data Daten
Hvid White Weiß	Shore A 60°
Art.	Ø mm
30.103SIH	3.0
30.104SIH	4.0
30.106SIH	6.0
30.108SIH	8.0